

**h=40**

**h=50**

**h=60**

**h=70**

**h=80**

**4 struny**

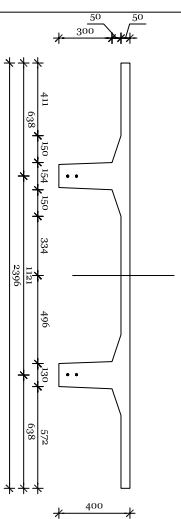

V = 0,2354 m<sup>3</sup>/mb  
 Q = 5,89 kN/mb  
 ciężna: 4 x 15,2mm - 4,37kg/mb

PLYTA  
 TT240.40.R60.4.13

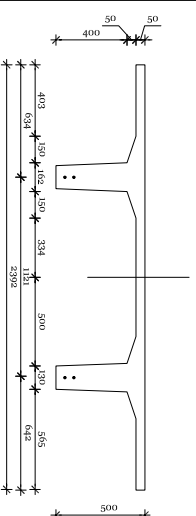

V = 0,2678 m<sup>3</sup>/mb  
 Q = 6,70 kN/mb  
 ciężna: 6 x 15,2mm - 4,37kg/mb

PLYTA  
 TT240.50.R60.4.13

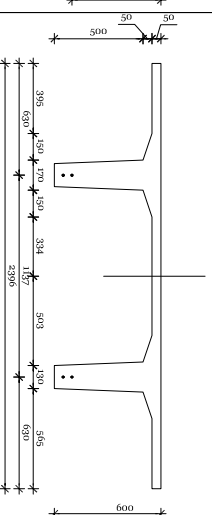

V = 0,3018 m<sup>3</sup>/mb  
 Q = 7,55 kN/mb  
 ciężna: 4 x 15,2mm - 4,37kg/mb

PLYTA  
 TT240.60.R60.4.13

**6 strun**

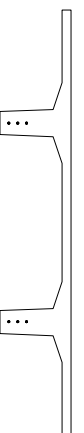

V = 0,2354 m<sup>3</sup>/mb  
 Q = 5,89 kN/mb  
 ciężna: 6 x 15,2mm - 6,57kg/mb

PLYTA  
 TT240.40.R60.4.13

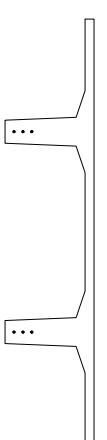

V = 0,2678 m<sup>3</sup>/mb  
 Q = 6,70 kN/mb  
 ciężna: 6 x 15,2mm - 6,57 kg/mb

PLYTA  
 TT240.50.R60.4.13

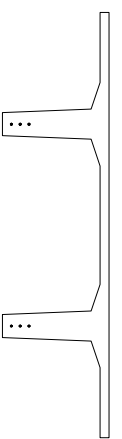

V = 0,3018 m<sup>3</sup>/mb  
 Q = 7,55 kN/mb  
 ciężna: 6 x 15,2mm - 6,57kg/mb

PLYTA  
 TT240.60.R60.4.13

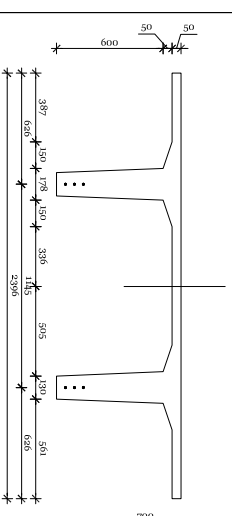

V = 0,3374 m<sup>3</sup>/mb  
 Q = 8,44 kN/mb  
 ciężna: 6 x 15,2mm - 6,57kg/mb

PLYTA  
 TT240.70.R60.6.13

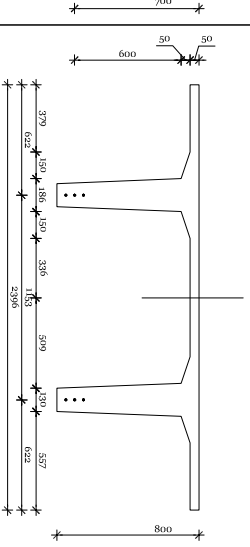

V = 0,3746 m<sup>3</sup>/mb  
 Q = 9,37 kN/mb  
 ciężna: 6 x 15,2mm - 6,57kg/mb

PLYTA  
 TT240.80.R60.6.13

**8 strun**

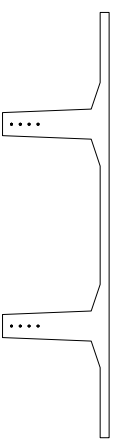

V = 0,3018 m<sup>3</sup>/mb  
 Q = 7,55 kN/mb  
 ciężna: 8 x 15,2mm - 8,76kg/mb

PLYTA  
 TT240.60.R60.8.13

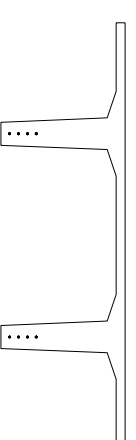

V = 0,3374 m<sup>3</sup>/mb  
 Q = 8,44 kN/mb  
 ciężna: 8 x 15,2mm - 8,76kg/mb

PLYTA  
 TT240.70.R60.8.13

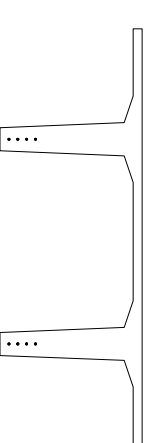

V = 0,3746 m<sup>3</sup>/mb  
 Q = 9,37 kN/mb  
 ciężna: 8 x 15,2mm - 8,76kg/mb

PLYTA  
 TT240.80.R60.8.13

**plyta TT**

szerokość płyty: 239,6cm  
 grubość półki: 5,0cm  
 szerokość żebra: 13,0cm  
 ognioodporność: R60

**10 strun**

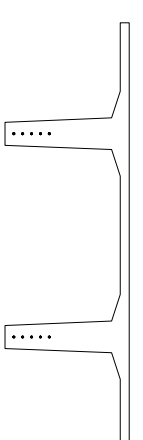

V = 0,3374 m<sup>3</sup>/mb  
 Q = 8,44 kN/mb  
 ciężna: 10 x 15,2mm - 10,95 kg/mb

PLYTA  
 TT240.70.R60.10.13

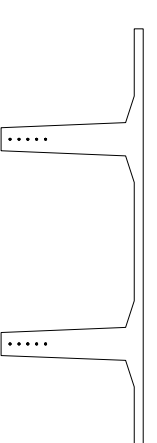

V = 0,3746 m<sup>3</sup>/mb  
 Q = 9,37 kN/mb  
 ciężna: 10 x 15,2mm - 10,95kg/mb

PLYTA  
 TT240.80.R60.10.13